

MODEL B

The Flagship of All Carriers

MODELS	B2-48	B2-54
TYPE	Electric	Electric
SPEED (MAX MPH)	12	7
RANGE (MILES)	24	24
LOAD CAPACITY (lbs)	3,000	6,000
TOWING CAPACITY (lbs)	12,500	17,500
BED SIZE (W"xL")	41x75	41x75
VOLTAGE	36	36



Tough and Dependable Product Solutions

The Model B series product line of Electric Personnel and Burden carriers offers the ultimate versatility in load capacity, vehicle configuration and vehicle performance. This unique modular vehicle design allows the Model B to be configured to provide precise solutions to your needs.

Model B series, equipped with electric drive train, provides years of reliability with low operating costs. Our worldwide sales staff is trained to discuss your needs and then configure a Model B to provide the most cost effective solution. This customization of products provides the best value for our customers while reducing acquisition costs.

We at Taylor-Dunn and our team of worldwide dealers pride ourselves in providing multiple solutions in single product configuration. Whether your application is carrying loads, towing loads, moving personnel, or all three, we can configure a single product to meet all your needs.

Model B can be configured to carry up to 5,000 lbs. of load, pull 17,500 lbs. of load, or carry up to 10 people. Equipped with an automotive differential matched to a 36 or 48 volt drive train, Model B is one of the best values for your utility applications.

With over 130,000 vehicles in service and over 50 years of experience in the industry, Taylor-Dunn products are the best way to go about your business.



TAYLOR-DUNN®
Commercial and Industrial Vehicles Since 1949

The best way to go about your business

PERSONNEL CARRIERS



Aristocrat



Roadmaster

BURDEN CARRIERS



Taylortruck



Loadmaster



Model B Series



Electruck



Maintenance Expediter



Stepsaver



Stockchaser

TOW TRACTORS



Towmaster



Mule



Pullmaster



Model E



Huskey

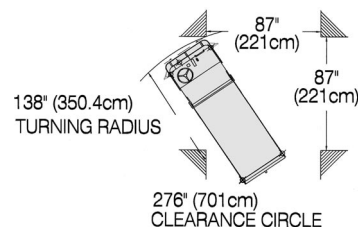
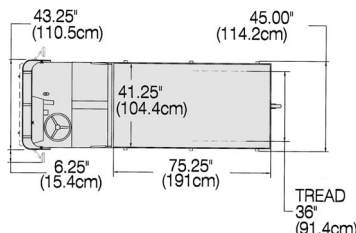
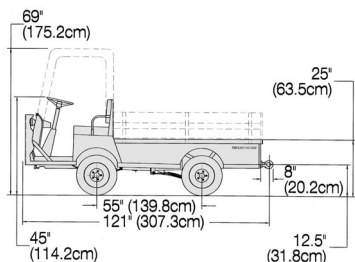

MODEL B STANDARD SPECIFICATIONS

Product Line: Model B 2-48

Wheels: 4 wheels

Unit Weight: 1,405 lbs (636 Kg.)

Load Capacity: 3,000 lb.

Battery Type (Lead Acid): 220 amp hours, 6 volts

System Voltage: 36 volt

Travel Distance (Unloaded): 24 miles

Energy Consumption: 264 watt/hr. per mile

Drive Axle: Automotive type differential and housing

Transmission: Power traction in oil bath; 14:1 reduction

Motor: NEMA rated 36V, 10 hp @ 1400 rpm intermittent duty, DC Series unload; 3.5 hp @2900 rpm normal duty

Speed (Unloaded): 12 mph

Gradeability: 15% empty, 5% fully loaded

Tires Pneumatic: 5.70x8 load range B

Brakes: Hydraulic disc brakes rear, hand operated parking brake

Steering: Automotive steering 24:1

Frame: All steel unitized body, heavy duty 16 gauge diamond plate steel

Bumper: Heavy duty steel front bumper



Suspension: Leaf springs front and rear, with rear shock absorber

Color: Safety orange, traffic yellow

Seats: Bench seat cushion, full back seat foam covered with vinyl

Controller: Solid state speed controller 400 amp 36 volt

Wiring: Modular harness design with weather protected connectors

Instrumentation: Battery discharge indicator, forward/reverse selector, key switch

Light Accessories: Headlight, taillight

Charger: 25 amp, 36 volt built in automatic charger

Charge Time: 8 hours for charge on batteries 80% discharged

Input Voltage: 110 volt/220 volt, 50 Hz./60Hz.

Charging Energy Requirements: 9.9 kw hr. @ 80% efficiency

Conformance Standards: Type E OSHA requirements 1910.178, ANSI B56.8 requirements

MODEL B2-48 HC

Load capacity 4,000 lbs.; 4 wheel hydraulic brakes; soft solid tires; 10 mph speed.

MODEL B2-54

Load capacity 5,000 lbs.; motor 15 hp @ 1400 rpm intermittent duty (5 hp @ 3000 rpm normal duty); 11 inch brakes rear; 18x5x14 solid cushion tires; overload coil springs and shock absorbers in rear; 7 mph speed.

MODEL B OPTIONAL FEATURES

Charger

- Portable 25 amp charger or 40 amp charger
- Built in 110V/220V 50 Hz.

Accessories

- Strobe light, amber - on pole, or top of cab
- Dual headlights, directional signals
- Reverse alarm, hour meter, seat brake
- Seat belts

Deck

- 1,000 lb. capacity, electric hydraulic dump body
- Stake sides, removable end gate, 14" high
- 96 inch bed length (extended wheel base)
- Welding tank cutouts
- Steel sides and end gates, fold down
- Steel panel cargo box

Battery Compartment

- 244 a.h. batteries
- Lift out/roll out battery box
- 48 volt battery option

Hitches

- Hitch automatic coupling, trailer

- Hitch pintle trailer
- Hitch, 1 7/8 ball and bracket

Brakes

- Front wheel hydraulic

Cab

- Steel cab with doors & safety glass
- Fiberglass cab & vinyl doors
- Mirrors - left, right and rear

Top Frames

- Fiberglass or surrey top cover with tubular frame

Frame

- Foldaway seat for 2 passengers
- Permanent seating 4-6 passengers
- Smooth skin

Color

- Azure blue, white, or special paint color
- Undercoating



TAYLOR-DUNN CORPORATION
Commercial and Industrial Vehicles Since 1949



METRO CROWN INTERNATIONAL
A TAYLOR-DUNN COMPANY



TIGER TRACTOR
A TAYLOR-DUNN COMPANY

2114 West Ball Road, Anaheim, CA 92804 • (714) 956-4040 • FAX (714) 956-3130
Toll Free (800) 688-8680 Visit our website: www.taylor-dunn.com